



Foodspace BCT8 LED Tube Series



Ideal Bakery Counter T8 LED Retrofit Solution.

L70 Rated to 50,000 hours.

180 Rotating End Caps

Fully CE Certified

120 Degree Beam Angle

Up To 2550 Lumens

Features

- 5 Year Warranty
- CE & TUV Certified
- L70 to 50,000 Hrs
- 120 Degree Beam Angle
- RoHS Compliant
- 180 Rotating End Caps

Benefits

- Up To 50% Energy Savings
- Zero Maintenance
- Improved Light Quality

Typical Applications

- Bakery Counters
- Food Production Facilities
- Bakery Display Areas
- Supermarkets
- Convenience Stores

The Di-Astrum Foodspace Bakery Counter (BC) T8 LED Tube is an ideal straight swap solution for bakery produce display. These LED fittings not only save energy and money but provide vibrant golden tones to highlight bread and bakery products in display, preparation and storage areas. These units are available in various sizes for complete flexibility. These IP20 tubes are constructed using an Aluminium Profile for heat management and PMMA diffuser and offered with Frosted Anti-Glare Lens. The BC T8 is L70 rated to 50,000 hours offered with a 5 Year Warranty. Please note that electronic ballast will need to be by passed by a qualified electrician.

Electrical Information

| | |
|-----------------|------------------|
| Nominal Wattage | 11-30W |
| Drive Current | N/A |
| Operating Temp | -20 °C to +40 °C |
| Power Factor | > 0.95 |
| THD | < 20% |
| Input Voltage | 220-240 VAC |
| CRI | > 80 |
| CCT | Yellow 2200K |

Mechanical Information

| | |
|-----------|---------------------|
| Size | 600 – 1500mm |
| Weight | 222 – 433g |
| Mounting | G13 Base |
| IP Rating | IP20 |
| IK Rating | IK01 |
| Housing | Aluminium / Plastic |
| Diffuser | PMMA |

Ordering Information

| Part Number | Wattage | Lumen Output | CCT / Colour Temperature |
|---------------------------|---------|--------------|--------------------------|
| DA-FDS-BCT8-60-11W-40P-FC | 11W | 935 | 2200K / Yellow |
| DA-FDS-BCT8-12-20W-40K-FC | 20W | 1700 | 2200K / Yellow |
| DA-FDS-BCT8-15-24W-40K-FC | 24W | 2040 | 2200K / Yellow |
| DA-FDS-BCT8-15-30W-40K-FC | 30W | 2550 | 2200K / Yellow |



Installation Instructions

1. Installation For Magnietic Ballast



ATTENTION Just replace starter with fuse for retrofit only suitable for batterns with magnetic ballast, not electronic ballast

2. Installation For Electronic Ballast

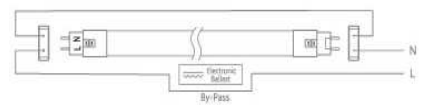

ATTENTION Electronic ballast must be by-passed by a registered electrician

3. Installation For Rewiring



ATTENTION Before installation please make sure the power is turner off.

4. Installation Step for Magnetic Ballast

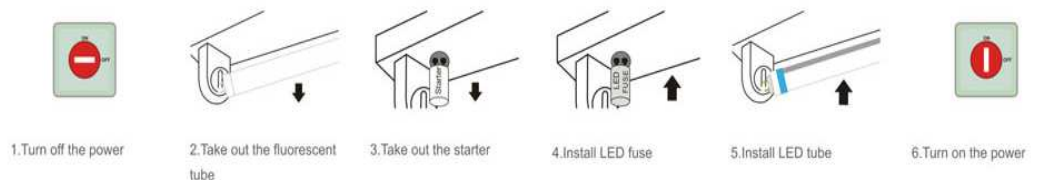

Features

- 5 Year Warranty
- CE & TUV Certified
- L70 to 50,000 Hrs
- 120 Degree Beam Angle
- RoHS Compliant
- 180 Rotating End Caps

Benefits

- Up To 50% Energy Savings
- Zero Maintenance
- Improved Light Quality

Typical Applications

- Bakery Counters
- Food Production Facilities
- Bakery Display Areas
- Supermarkets
- Convenience Stores